

# SURVEYOR'S RECORD

Section 10

Township 106

Range 39

Cor. Maple 430

B 325 F. cor.

266 76

F. Cor. 385 386 F. Cor.  
7.0388

10  
11

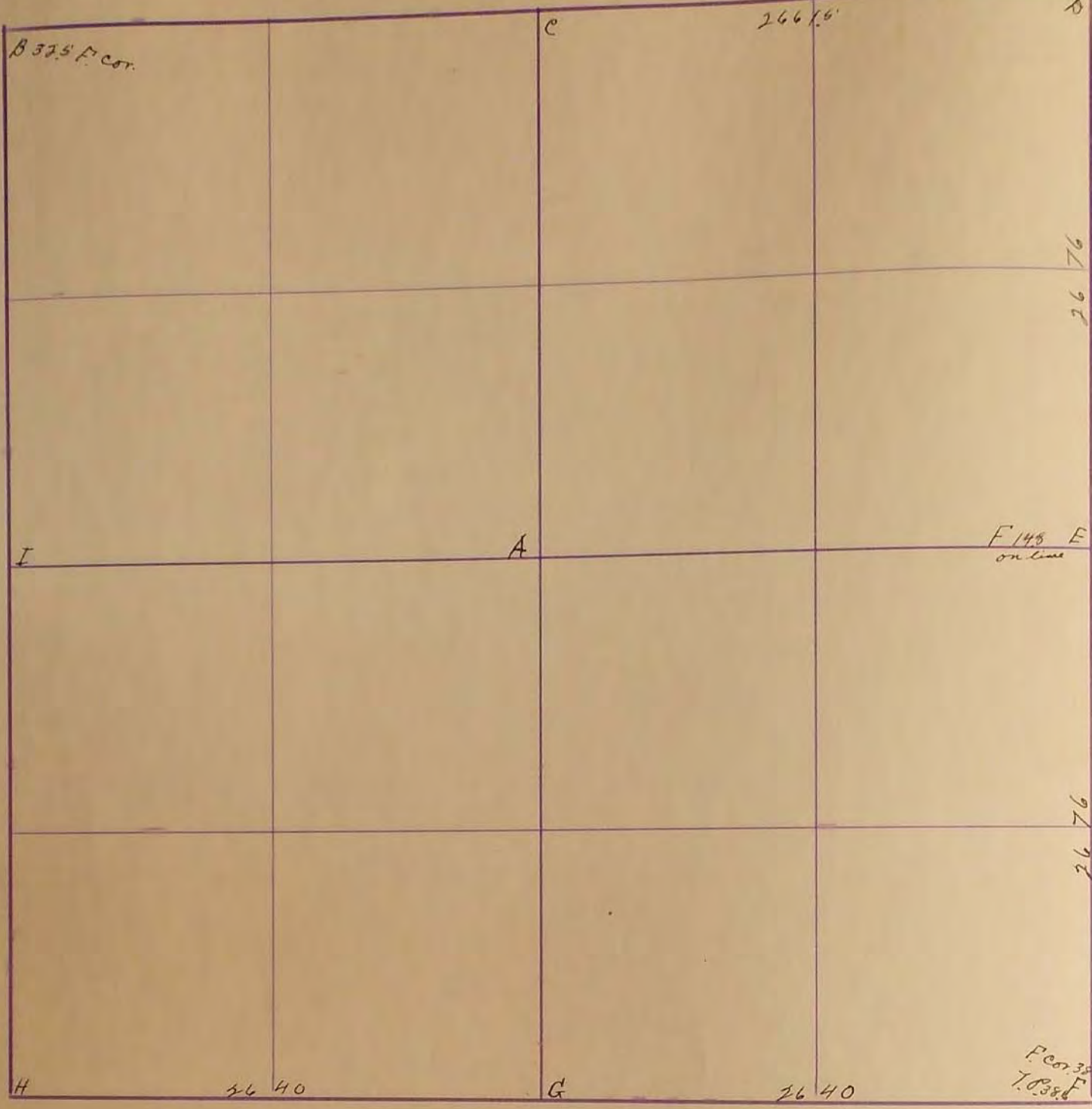

July 5 1911

J. W. Woelke

B. corner Maple 12" 43' N.W. Fence cor. 325 S.E. stone

"B" F. corner 392' S.W.

M.E. Koopman 1954

S.W. of line between two References

Feb 6-1934

"B" concrete stone with +: R.P. Loek in cor. of fence post N.W. 46.7' R.P. Loek in corner of fence post N.E. 46.9'

"E" concrete stone with + R.P. Loek in cor. E on line 34.7' R.P. Loek in gate Post no E. 429'

"F" concrete stone with +: R.P. Loek in cor. fence Post S.E. 43.4' R.P. Loek in 1st Pole N.W. 49.0'

7.9. March



SURVEY No. \_\_\_\_\_

Sec. 12 43.0

Section \_\_\_\_\_

Town 116

Range 39



FIELD NOTES.

July, 5, 1911

J.W. Woodstencroft

B. Corner Maple 12° 43' N.W. Fence cor. 32.5 S.E. stone 2' SW of line between two references

February 5, 1937

- "D" - Concrete stone with +; R.P. Tack in corner fence post N.W. 46.7' - R.P.
- "E" - Tack in corner fence post N.E. 46.9'
- "E" - Concrete stone with +; R.P. Tack in corner fence post East on line 34.7'
- "F" - R.P. Tack in gate post N.E. 42.8'
- "F" - Concrete stone with +; R.P. Tack in corner fence post S.E. 43.4; R.P. Tack in tel. pole N.W. 49.0'

M. Koopman April 13-1954 J.A. March  
B. F. Corner 39.2 S.W.